

WBS NO: 2026CPT.03.13.20672

CONTRACT: DC00489

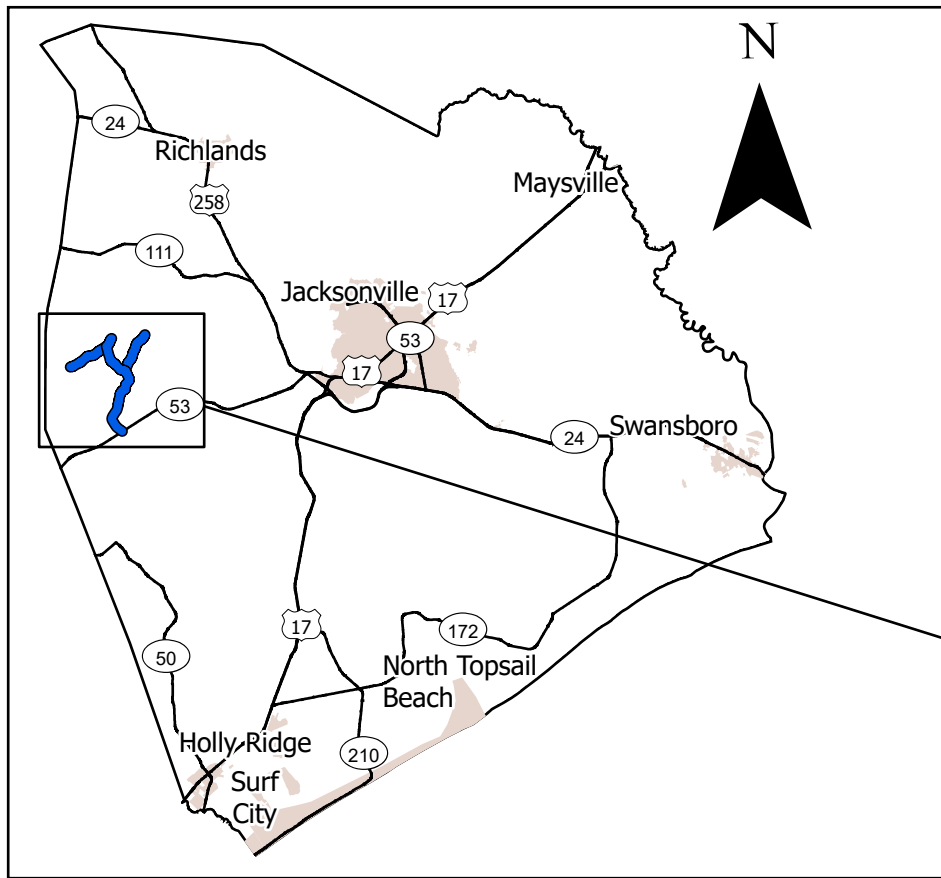

**STATE OF NORTH CAROLINA  
DIVISION OF HIGHWAYS  
DISTRICT 1 ONSLOW COUNTY**

*TYPE OF WORK: PRESERVATION*

STATE	STATE PROJECT REFERENCE NUMBER	SHEET NO.
NC	2026CPT.03.13.20672	1
STATE PROJECT NUMBER		DESCRIPTION

- Preservation
- Division 3 Bridges

MAP	ROUTE	DESCRIPTION	TYPE
1	SR-1204 / DAVIS RD	FROM SR 1203 (BEN WILLIAMS RD) TO SR 1203 (NINE MILE RD) [MP 0.00 - MP 1.90]	Preservation
2	SR-1207 / HEWITT RD	FROM SR 1203 (NINE MILE RD) TO SR 1201 (GURGANUS RD) [MP 0.00 - MP 1.90]	Preservation
3	SR-1203 / NINE MILE RD	FROM NC 53 (BURGAW HWY) TO SR 1205 (BATCHELOR RD) [MP 0.00 - MP 5.12]	Preservation

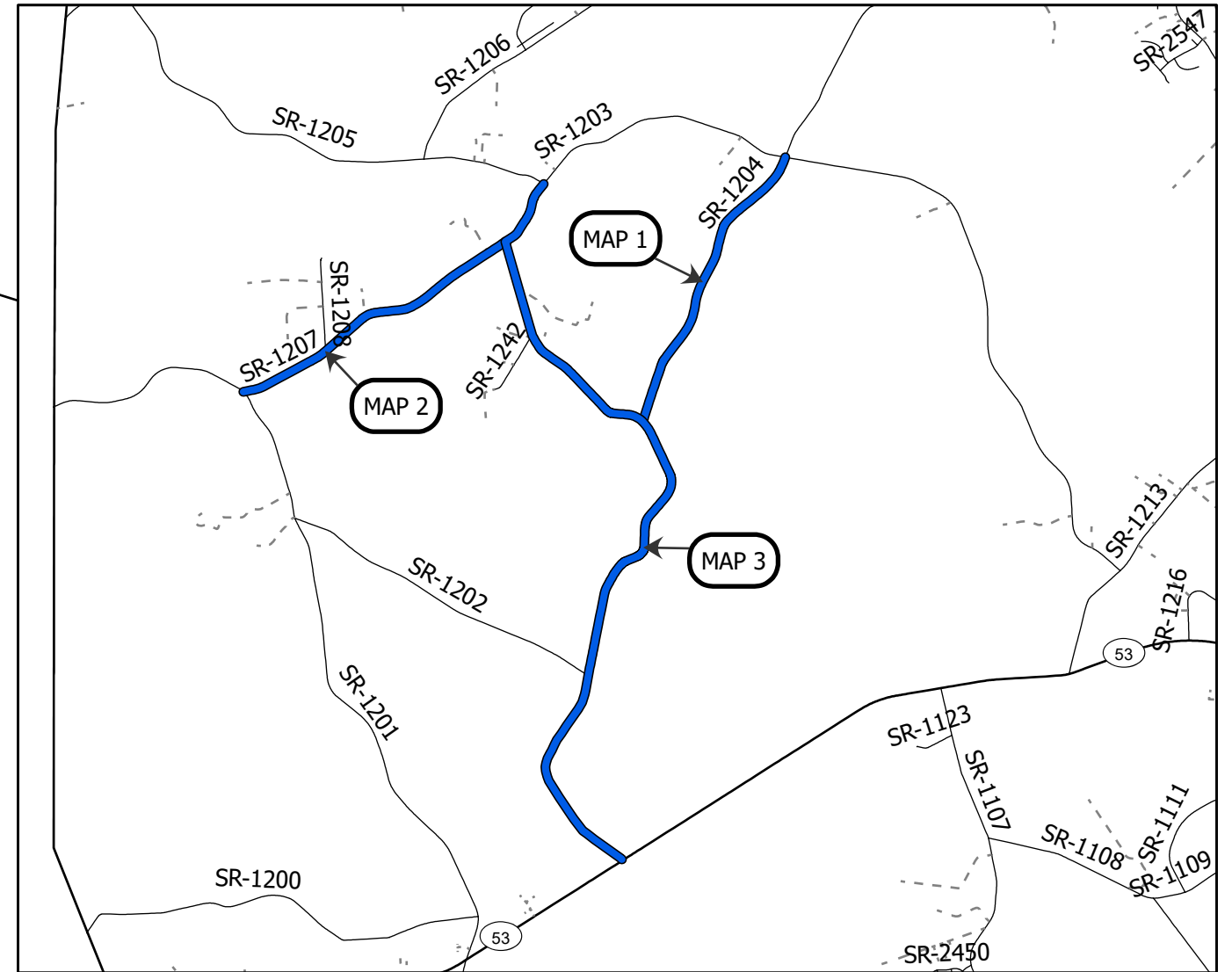

**PROJECT LENGTH**

MAP	MILES
1	1.90
2	1.90
3	5.12

Prepared in the Office of:  
**DIVISION OF HIGHWAYS**  
5501 BARBADOS BLVD., CASTLE HAYNE, NC, 28429

This exhibit does not meet NC 47-30 requirements and therefore is not intended for design, construction, or recording or transfer of title.



WBS NO: 36249.5092

CONTRACT: DC00489

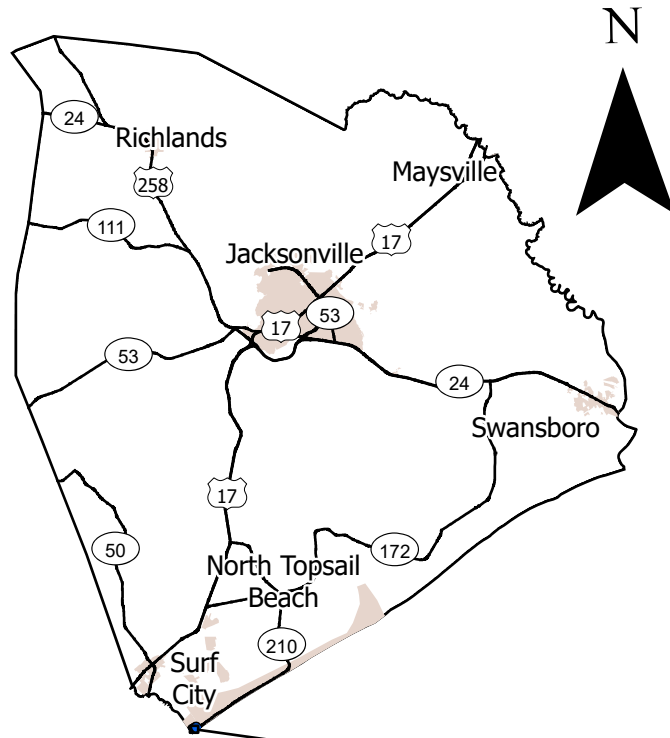

**STATE OF NORTH CAROLINA  
DIVISION OF HIGHWAYS  
DISTRICT 1 ONSLOW COUNTY**

*TYPE OF WORK: PRESERVATION*

STATE	STATE PROJECT REFERENCE NUMBER	SHEET NO.
NC	36249.5092	2
STATE PROJECT NUMBER		DESCRIPTION

— Preservation

MAP	ROUTE	DESCRIPTION	TYPE
4	2ND ST	FROM (CANAL ST) TO NC 210 (N NEW RIVER DR)[MP 0.00 - MP 0.09]	Preservation
5	3RD ST	FROM (CANAL ST) TO NC 210 (N NEW RIVER DR)[MP 0.00 - MP 0.09]	Preservation
6	4TH ST	FROM (CANAL ST) TO NC 210 (N NEW RIVER DR)[MP 0.00 - MP 0.09]	Preservation
7	5TH ST	FROM (CANAL ST) TO NC 210 (N NEW RIVER DR)[MP 0.00 - MP 0.09]	Preservation
8	6TH ST	FROM (CANAL ST) TO NC 210 (N NEW RIVER DR)[MP 0.00 - MP 0.09]	Preservation
9	7TH ST	FROM (CANAL ST) TO NC 210 (N NEW RIVER DR)[MP 0.00 - MP 0.08]	Preservation

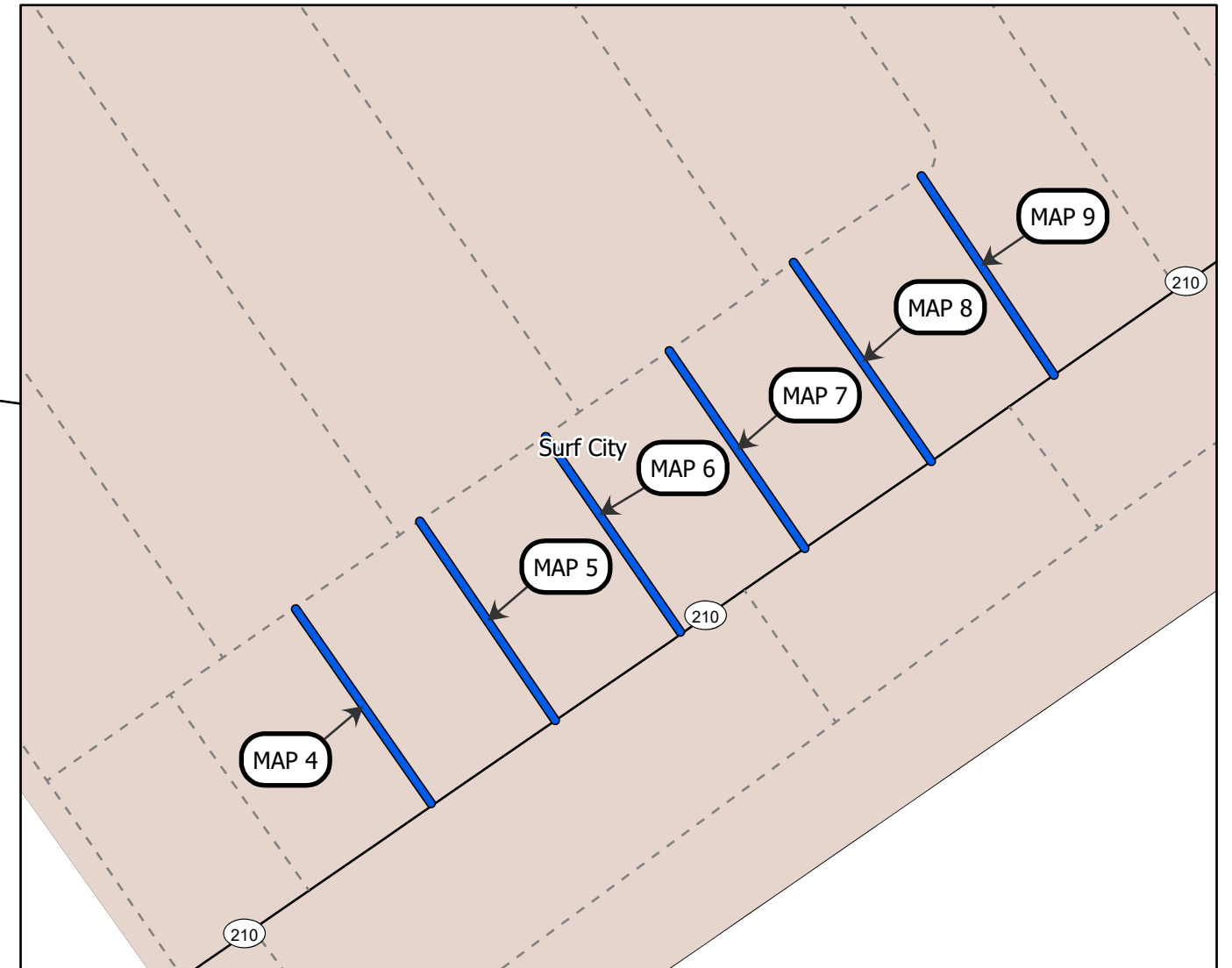

**PROJECT LENGTH**

MAP	MILES
4	0.09
5	0.09
6	0.09

MAP	MILES
7	0.09
8	0.09
9	0.08

Prepared in the Office of:  
**DIVISION OF HIGHWAYS**  
5501 BARBADOS BLVD., CASTLE HAYNE, NC, 28429

This exhibit does not meet NC 47-30 requirements and therefore is not intended for design, construction, or recording or transfer of title.



PAVEMENT SCHEDULE	
C1	PROP. CRACK SEALANT AN AVERAGE RATE OF .25 LBS. PER SQ.YD.
C2	PROP. ASPHALT SURFACE TREATMENT, EMULSION, GRADE CRS-2P.
C3	PROP. ASPHALT SURFACE TREATMENT, TYPE MATCOAT, (SINGLE SEAL).
C4	PROP. MICROSURFACING SINGLE COURSE, TYPE III.
C5	PROP. ASPHALT SURFACE TREATMENT, FOG SEAL.
C6	PROP. MICROSURFACING SINGLE COURSE, TYPE II.
U	EXISTING PAVEMENT

PAVEMENT EDGE SLOPES ARE 1:1, EXCEPT FINAL SURFACE COURSE. SEE SHOULDER WEDGE DETAIL.

REVISIONS  
 8/17/99  
 SYSTEMS

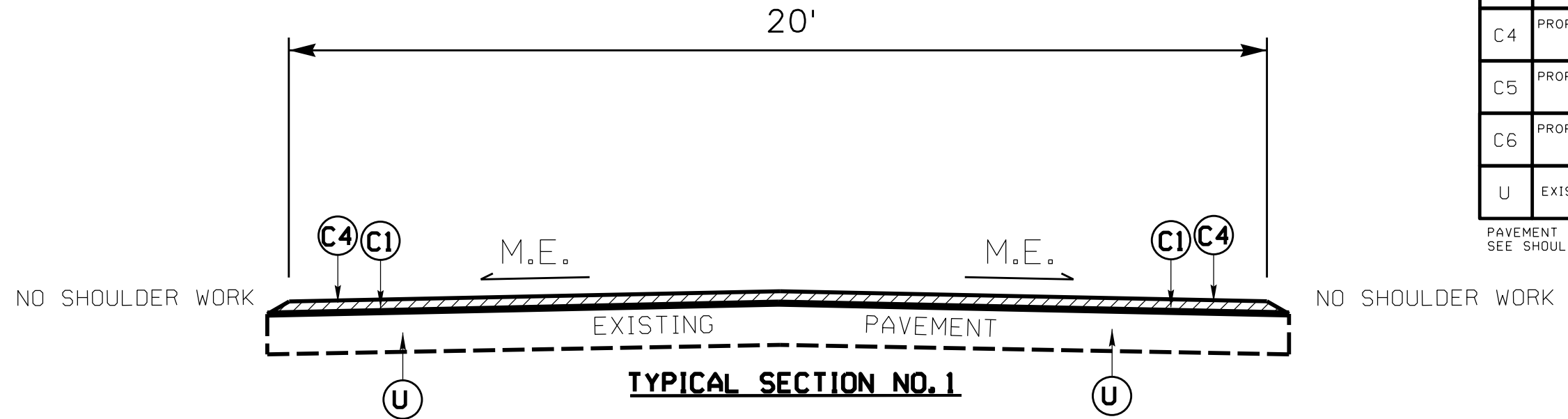

MAP NO. 1  
 SR 1204 (DAVIS RD)  
 MP 0.00 - MP 1.90

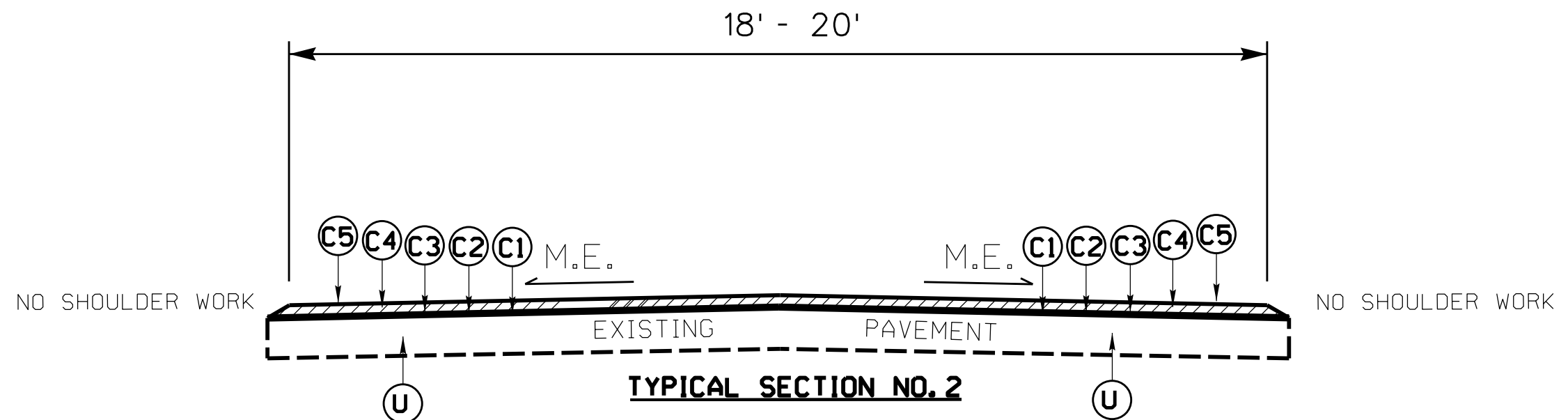

MAP NO. 2  
 SR 1207 (HEWITT RD)  
 MP 0.00 - MP 1.90

MAP NO. 3  
 SR 1203 (NINE MILE RD)  
 MP 0.00 - MP 5.12







LEGEND	
	PORTABLE SIGN
	STATIONARY SIGN
	DIRECTION OF TRAFFIC FLOW

## SIGNING FOR ASPHALT SURFACE TREATMENT

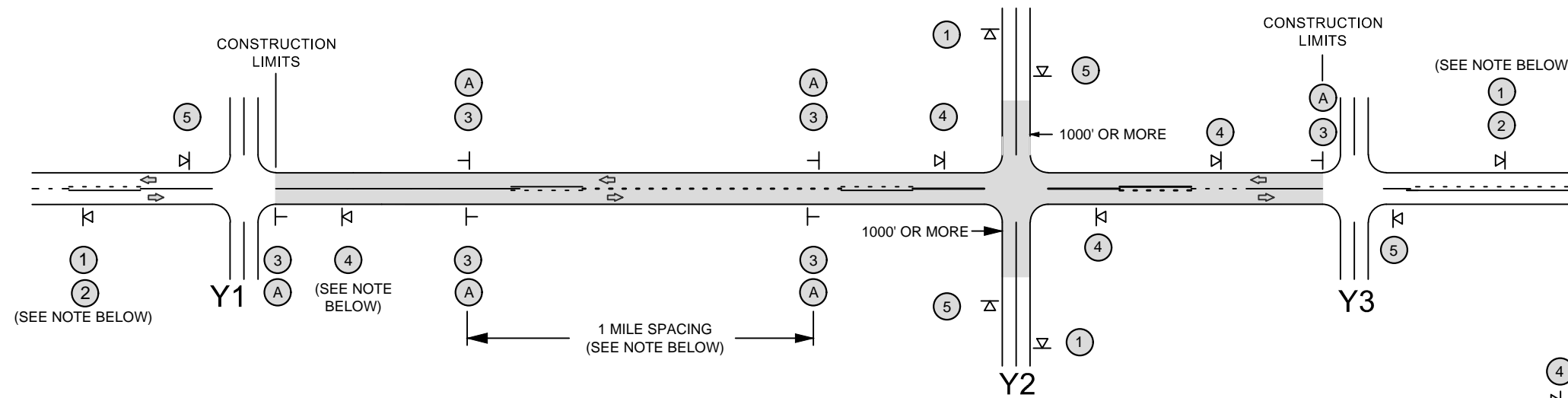

### MAINLINE (-L-) SIGNING

### -Y- LINE SIGNING

SIGNING NOTES AND PLACEMENT PER DIRECTION	<p>①  48" X 48"</p> <p>②  24" X 18"</p>	<p>- PLACE 1000' PRIOR TO BEGINNING OF CONSTRUCTION LIMITS. ONLY USED ON -Y- LINES IF RESURFACING LIMITS EXTEND 1000' ALONG -Y- LINE.</p> <p>- SIGN #2 ONLY USED WHEN RESURFACING LIMITS ARE 2 OR MORE MILES IN LENGTH. ROUND UP TO THE NEAREST WHOLE NUMBER. DO NOT USE FRACTIONAL OR DECIMAL NUMBERS.</p>	<p>STATIONARY SIGNING NOT REQUIRED FOR THE FOLLOWING -Y- LINE CONDITIONS:</p> <ol style="list-style-type: none"> <li>1) LESS THAN 1000' OF RESURFACING ALONG -Y- LINE</li> <li>2) SUBDIVISION ROADS</li> <li>3) DEAD END ROADS</li> </ol> <p>WHEN PAVING/CONSTRUCTION ACTIVITIES PROCEED ACROSS AN UNSIGNED -Y- LINE, PORTABLE ADVANCE WARNING SIGNS SHALL BE USED ALONG THE -Y- LINE AS SHOWN BELOW. REMOVE UPON COMPLETION OF WORK.</p> <div style="display: flex; justify-content: space-around;"> <div style="text-align: center;"> <p>PLACED 500' IN ADVANCE OF FLAGGER.</p> </div> <div style="text-align: center;"> <p>PLACED 250' IN ADVANCE OF FLAGGER.</p> </div> </div>
	<p>③  48" X 48"</p> <p> 48" X 48"</p>	<p>- ALTERNATE THE FOLLOWING TWO SIGNS:</p> <p>- STARTING WITH "LOOSE GRAVEL" (W8-7) FOLLOWED BY "UNMARKED PAVEMENT".</p> <p>- PLACE INITIALLY AT THE CONSTRUCTION LIMITS AND SPACED 1 MILE APART THEREAFTER.</p> <p>- AT TEE INTERSECTIONS INSTALL INITIALLY 0.5 MILE FROM INTERSECTION AND SPACE 1 MILE APART THEREAFTER.</p>	
	<p>A  18" X 18"</p>	<p>PLACE INITIALLY AT THE CONSTRUCTION LIMITS AND SPACED 1 MILE APART THEREAFTER. IF NO -Y- LINES EXIST, PLACE 2ND SET 1/2 MILE FROM THE CONSTRUCTION LIMITS AND THEN SPACE 1 MILE THEREAFTER. SPEED LIMIT SIGN MAY BE PLACED ON SAME POST AS LOOSE GRAVEL SIGN, IF DESIRED.</p>	
	<p>④  48" X 48"</p>	<p>- THESE ARE FOR -Y- LINES THAT ARE "THROUGH" ROADWAYS. DEAD END AND SUBDIVISION ROADS ARE NOT "THROUGH" ROADWAYS.</p> <p>- INSTALL 500' +/- FROM EACH -Y- LINE APPROACH AS SHOWN ABOVE.</p> <p>- FOR MULTIPLE -Y- LINES THAT ARE SEPARATED BY 0.25 MILES OR LESS, TREAT AS A SINGLE UNIT AND INSTALL WITHIN 500' OF EACH APPROACH.</p> <p>- A MAXIMUM OF 2 SIGN SETS PER MILE. DO NOT INSTALL WHEN -Y- LINES ARE WITHIN 0.5 MILES FROM "END ROAD WORK" SIGN.</p>	
	<p>⑤  48" X 24"</p>	<p>PLACE 500' FOLLOWING THE END OF CONSTRUCTION LIMITS OR AS SHOWN WHEN WORK ENDS AT A 3-WAY TEE INTERSECTION.</p>	

**NOTE:**  
IT IS THE CONTRACTOR'S RESPONSIBILITY TO ENSURE THE PROPER PLACEMENT AND LOCATION OF WORK ZONE SIGNING PER THE STANDARD DRAWING. NCDOT HAS THE RIGHT TO INSPECT THE PLANNED LOCATIONS AND REQUIRE ADJUSTMENT BY THE CONTRACTOR, AS NEEDED, OR AS DIRECTED BY THE ENGINEER.

**MAPS LESS THAN 1 MILES**

FOR AST RESURFACING MAPS WITH CONSTRUCTION LIMITS LESS THAN 2 MILES IN LENGTH, USE A STATIONARY "LOOSE GRAVEL" SIGN AT THE BEGINNING CONSTRUCTION LIMIT FOLLOWED BY AN "UNMARKED PAVEMENT" SIGN MIDWAY THROUGH AND AN "END ROAD WORK" SIGN AT THE END CONSTRUCTION LIMIT.

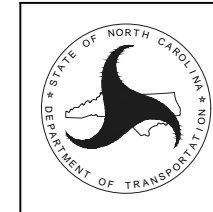

REVISED - 12-13-2018

NCDOT - DIVISION 6

ADVANCE WARNING SIGNS FOR 2-LANE ROADWAY ASPHALT SURFACE TREATMENT

PROJECT NO.	SHEET NO.
2026CPT.03.13.20672	7
36249.5092	

## SUMMARY OF QUANTITIES

PROJECT NO	COUNTY	MAP NO	ROUTE	DESCRIPTION	TYP NO	LANES	LANE TYPE	LENGTH	WIDTH	BEGI	END	1575000000-E	1705500000-E	1775000000-E	1022000000-E	1820000000-E	1838000000-E	1891000000-E	2830000000-N		
								MI	FT	N MP	MP	ASPHALT BINDER FOR PLANT MIX	PATCHING EXISTING PAVEMENT (MILL)	ASPHALT SURFACE TREATMENT, MATCOAT, #78M STONE	SEALING EXISTING PAVEMENT CRACKS	ASPHALT SURFACE TREATMENT, FOG SEAL	EMULSION FOR ASPHALT SURFACE TREATMENT, GRADE CRS-2P	MICRO SURFACING SINGLE COURSE, TYPE III	MICRO SURFACING SINGLE COURSE, TYPE II	ADJUSTMENT OF MANHOLES	
								TON	TON			TON	TON	SY	LB	SY	GAL	SY	SY	EA	
2026CPT.03.13.20672	Onslow	1	SR-1204 / DAVIS RD	FROM SR 1203 (BEN WILLIAMS RD) TO SR 1203 (NINE MILE RD) [MP 0.00 - MP 1.90]	1	2	2WU	1.90	20	0.00	1.90	4	5			3,000			22,293		
<b>TOTAL FOR MAP NO. 1</b>								<b>1.90</b>				<b>4</b>	<b>5</b>			<b>3,000</b>			<b>22,293</b>		
2026CPT.03.13.20672	Onslow	2	SR-1207 / HEWITT RD	FROM SR 1203 (NINE MILE RD) TO SR 1201 (GURGANUS RD) [MP 0.00 - MP 1.90]	1	2	2WU	1.90	18	0.00	1.90	4	5	20,064	3,000	20,064	6,020	20,064			
<b>TOTAL FOR MAP NO. 2</b>								<b>1.90</b>				<b>4</b>	<b>5</b>	<b>20,064</b>	<b>3,000</b>	<b>20,064</b>	<b>6,020</b>	<b>20,064</b>			
2026CPT.03.13.20672	Onslow	3	SR-1203 / NINE MILE RD	FROM NC 53 (BURGAW HWY) TO SR 1205 (BATCHELOR RD) [MP 0.00 - MP 5.12]	1	2	2WU	5.12	20	0.00	5.12	7	5	60,075	8,000	60,075	18,025	60,075		1	
<b>TOTAL FOR MAP NO. 3</b>								<b>5.12</b>				<b>7</b>	<b>5</b>	<b>60,075</b>	<b>8,000</b>	<b>60,075</b>	<b>18,025</b>	<b>60,075</b>			<b>1</b>
<b>TOTAL FOR PROJ NO. 2026CPT.03.13.20672</b>								<b>8.92</b>				<b>15</b>	<b>15</b>	<b>80,139</b>	<b>14,000</b>	<b>80,139</b>	<b>24,045</b>	<b>102,432</b>			<b>1</b>
36249.5092	Onslow - Surf City	4	2ND ST	NC210 TO CANAL ST	2	2	2WU	0.09	18	0.00	0.09	1	2						957		
<b>TOTAL FOR MAP NO. 4</b>								<b>0.09</b>				<b>1</b>	<b>2</b>							<b>957</b>	
36249.5092	Onslow - Surf City	5	3RD ST	NC210 TO CANAL ST	2	2	2WU	0.09	18	0.00	0.09	1	2						937		
<b>TOTAL FOR MAP NO. 5</b>								<b>0.09</b>				<b>1</b>	<b>2</b>						<b>937</b>		
36249.5092	Onslow - Surf City	6	4TH ST	NC210 TO CANAL ST	2	2	2WU	0.09	18	0.00	0.09	1	2						955		
<b>TOTAL FOR MAP NO. 6</b>								<b>0.09</b>				<b>1</b>	<b>2</b>						<b>955</b>		
36249.5092	Onslow - Surf City	7	5TH ST	NC210 TO CANAL ST	2	2	2WU	0.09	18	0.00	0.09	1	2						904		
<b>TOTAL FOR MAP NO. 7</b>								<b>0.09</b>				<b>1</b>	<b>2</b>						<b>904</b>		
36249.5092	Onslow - Surf City	8	6TH ST	NC210 TO CANAL ST	2	2	2WU	0.09	18	0.00	0.09	1	2						934		
<b>TOTAL FOR MAP NO. 8</b>								<b>0.09</b>				<b>1</b>	<b>2</b>						<b>934</b>		
36249.5092	Onslow - Surf City	9	7TH ST	NC210 TO CANAL ST	2	2	2WU	0.08	18	0.00	0.08	1	2						935		
<b>TOTAL FOR MAP NO. 9</b>								<b>0.08</b>				<b>1</b>	<b>2</b>						<b>935</b>		
<b>TOTAL FOR PROJ NO. 36249.5092</b>								<b>0.51</b>				<b>6</b>	<b>12</b>							<b>5,622</b>	
<b>GRAND TOTAL</b>								<b>9.43</b>				<b>21</b>	<b>27</b>	<b>80,139</b>	<b>14000</b>	<b>80,139</b>	<b>24,045</b>	<b>102,432</b>	<b>5,622</b>	<b>1</b>	

PROJECT NO.	SHEET NO.
2026CPT.03.13.20672	8
36249.5092	

## THERMOPLASTIC AND PAINT QUANTITIES

PROJECT NO	COUNTY	MAP NO	ROUTE	DESCRIPTION	TYP NO	LANES	LANE TYPE	LENGTH	WIDTH	BEGIN MP	END MP	4413000000-E	4457000000-N	4685000000-E	4688000000-E	4709000000-E	4810000000-E	4850000000-E	4870000000-E	4890000000-E	4900000000-N				
								MI	FT			WORK ZONE ADVANCE/GENERAL WARNING SIGNING	TEMPORARY TRAFFIC CONTROL	4" X 90 M WHITE THERMO	4" X 90 M YELLOW THERMO	6" X 90 M YELLOW THERMO	THERMOPLASTIC PAVEMENT MARKING LINES (24" X 90 MILS)	4" WHITE PAINT	4" YELLOW PAINT	REMOVAL OF PAVEMENT MARKING LINES (4")	REMOVAL OF PAVEMENT MARKING LINES (24")	THERMOPLASTIC PROFILED PAVEMENT MARKING LINES (6", 90 M)	YELLOW & YELLOW MARKERS		
								SF	LS	LF	LF	LF	LF	LF	LF	LF	LF	LF	LF	EA					
2026CPT.03.13.20672	Onslow	1	SR-1204 / DAVIS RD	FROM SR 1203 (BEN WILLIAMS RD) TO SR 1203 (NINE MILE RD) [MP 0.00 - MP 1.90]	1	2	2WU	1.90	20	0.00	1.90	212	0.20	40,888	25,080							83			
<b>TOTAL FOR MAP NO. 1</b>								<b>1.90</b>				<b>212</b>	<b>0.20</b>	<b>40,888</b>	<b>25,080</b>			<b>81,776</b>	<b>50,160</b>	<b>65,968</b>		<b>83</b>			
2026CPT.03.13.20672	Onslow	2	SR-1207 / HEWITT RD	FROM SR 1203 (NINE MILE RD) TO SR 1201 (GURGANUS RD) [MP 0.00 - MP 1.90]	2	2	2WU	1.90	18	0.00	1.90	212	0.20			25,080						84			
<b>TOTAL FOR MAP NO. 2</b>								<b>1.90</b>				<b>212</b>	<b>0.20</b>			<b>25,080</b>		<b>81,776</b>	<b>50,160</b>	<b>64,145</b>		<b>40,888</b>	<b>84</b>		
2026CPT.03.13.20672	Onslow	3	SR-1203 / NINE MILE RD	FROM NC 53 (BURGAW HWY) TO SR 1205 (BATCHELOR RD) [MP 0.00 - MP 5.12]	2	2	2WU	5.12	20	0.00	5.12	574	0.54			60,808						224			
<b>TOTAL FOR MAP NO. 3</b>								<b>5.12</b>				<b>574</b>	<b>0.54</b>			<b>60,808</b>		<b>220,364</b>	<b>121,616</b>	<b>172,855</b>		<b>110,182</b>	<b>224</b>		
<b>TOTAL FOR PROJ NO. 2026CPT.03.13.20672</b>								<b>8.92</b>				<b>998</b>	<b>0.95</b>	<b>40,888</b>	<b>25,080</b>	<b>85,888</b>		<b>383,916</b>	<b>221,936</b>	<b>302,968</b>		<b>151,070</b>	<b>391</b>		
												<b>65,968</b>				<b>605,852</b>									
36249.5092	Onslow - Surf City	4	2ND ST	NC210 TO CANAL ST	3	2	2WU	0.09	18	0.00	0.09	10	0.009									12			
<b>TOTAL FOR MAP NO. 4</b>								<b>0.09</b>				<b>10</b>	<b>0.01</b>			<b>12</b>						<b>12</b>			
36249.5092	Onslow - Surf City	5	3RD ST	NC210 TO CANAL ST	3	2	2WU	0.09	18	0.00	0.09	10	0.009									12			
<b>TOTAL FOR MAP NO. 5</b>								<b>0.09</b>				<b>10</b>	<b>0.01</b>			<b>12</b>						<b>12</b>			
36249.5092	Onslow - Surf City	6	4TH ST	NC210 TO CANAL ST	3	2	2WU	0.09	18	0.00	0.09	10	0.009									12			
<b>TOTAL FOR MAP NO. 6</b>								<b>0.09</b>				<b>10</b>	<b>0.01</b>			<b>12</b>						<b>12</b>			
36249.5092	Onslow - Surf City	7	5TH ST	NC210 TO CANAL ST	3	2	2WU	0.09	18	0.00	0.09	10	0.009									12			
<b>TOTAL FOR MAP NO. 7</b>								<b>0.09</b>				<b>10</b>	<b>0.01</b>			<b>12</b>						<b>12</b>			
36249.5092	Onslow - Surf City	8	6TH ST	NC210 TO CANAL ST	3	2	2WU	0.09	18	0.00	0.09	10	0.009									12			
<b>TOTAL FOR MAP NO. 8</b>								<b>0.09</b>				<b>10</b>	<b>0.01</b>			<b>12</b>						<b>12</b>			
36249.5092	Onslow - Surf City	9	7TH ST	NC210 TO CANAL ST	3	2	2WU	0.08	18	0.00	0.08	10	0.009									12			
<b>TOTAL FOR MAP NO. 9</b>								<b>0.08</b>				<b>10</b>	<b>0.01</b>			<b>12</b>						<b>12</b>			
<b>TOTAL FOR PROJ NO. 36249.5092</b>								<b>0.51</b>				<b>60</b>	<b>0.05</b>			<b>72</b>							<b>72</b>		
<b>GRAND TOTAL</b>								<b>9.43</b>				<b>1,058</b>	<b>1</b>	<b>40,888</b>	<b>25,080</b>	<b>85,888</b>		<b>72</b>	<b>383,916</b>	<b>221,936</b>	<b>302,968</b>		<b>72</b>	<b>151,070</b>	<b>391</b>
												<b>65,968</b>				<b>605,852</b>									